

A Villa Lifestyle that doesn't belong to any competition

Spring Villas, opposite Radha Soami Sahasg Beas, main tank road Jaipur, boasts an array of facilities and amenities spread across 91 acres that are not only unique but class defining as well. Spring Villas offers a unique experience of villa lifestyle where luxury paints various shades of a dream life. Each villa here is a fine blend of meticulously designed architecture and choicest amenities. The idea of Spring Villas carries the elements of freedom in its design DNA. Expect carefree moments in the lap of defining luxury and live a life full of amazing moments and memories. It's your turn to claim a life without any penitents.





COME, EXPERIENCE
A FRESH PERSPECTIVE OF
**Luxurious
Villa Living**

life is well- connected

You always need your dream home to be out-of-the-world yet well-connected to the world that matters. Mahima's Spring Villas is ideally located on happening main Tank Road where you are within 20 minutes reach from everything you need or desire. Be well-connected without facing the hustle and bustle of the busy city life.

KEY DISTANCES:

Sri Venkateswara Temple - 24Kms	Mahima Garden Hospital - 10Kms
Chaitanyacharya - 6 Kms	Food Mart - 10 Kms
Chaitanya Mall - 6.7 Kms	Theraputic Paradise - 15 Kms
Swamiji Park - 7 Kms	Wu Ji Park - 20 Kms
Swamiji Temple - 12 Kms	Upari International Sports - 20 Kms
Swamiji Mahalaya Hospital - 15 Kms	Swamiji Mahalaya Hospital - 20 Kms



spring
villas
at mahima sansaar





Life is Luxurious

Spring Villa brings the best in luxury and design in every aspect of its planning. Aesthetic design and handpicked luxurious amenities make Spring Villa a unique place of rich experiences and delightful living. Come here and embrace a life that aptly illustrates a happening picture of a life beyond imagination.



PLAY IN THE FRONT FOOT. APPLAUSE GUARANTEED.
CRICKET GROUND



MAKE JOY YOUR ULTIMATE GOAL. YOUR TURN IS NOW.
FOOTBALL GROUND



PUSH & PULL. FORGET THE DOOR STICKERS.
INDOOR GYMNASIUM



CHOOSE YOUR RACE. LET THE TIME RUN.
CYCLING & JOGGING TRACKS

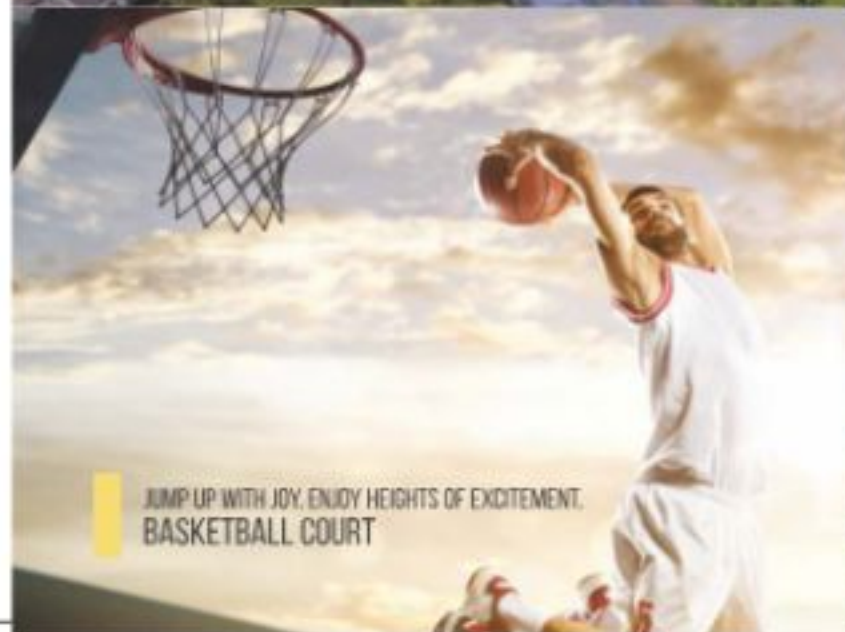

JUMP UP WITH JOY. ENJOY HEIGHTS OF EXCITEMENT.
BASKETBALL COURT



COME IN THE COURT. WIN THE MOMENTS.
TENNIS COURT



WALL WILL NOT MOVE. AND YOU WILL NOT STOP.
SQUASH COURT



IT'S A GYM WITHOUT WALLS.
OUTDOOR GYMNASIUM



PLAY WITH ONE PARTNER. GET MANY MORE SHUTTLES.
BADMINTON COURT

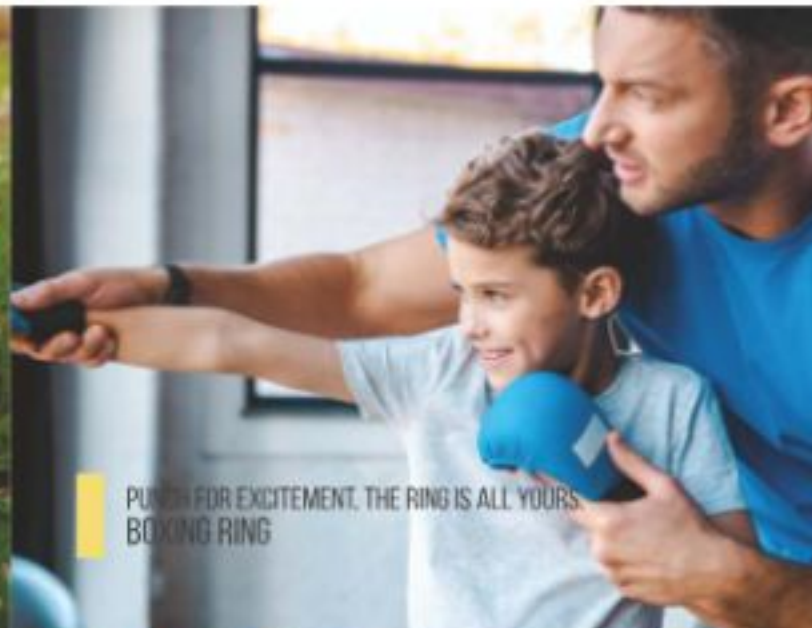

PUNCH FOR EXCITEMENT. THE RING IS ALL YOURS.
BOXING RING



ENOUGH OF GROUND WALK. WALK VERTICALLY. LITERALLY.
ROCK CLIMBING

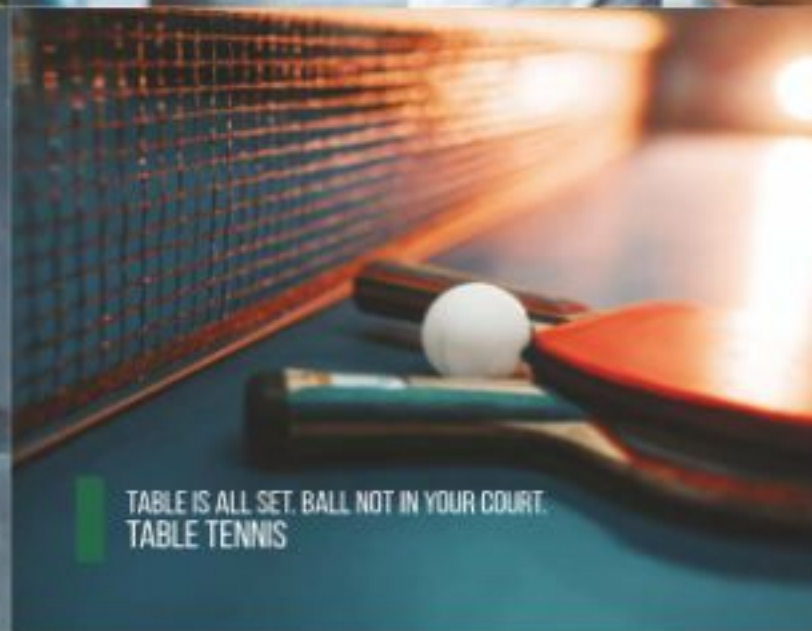

TABLE IS ALL SET. BALL NOT IN YOUR COURT.
TABLE TENNIS



JUST OCCASION IS NOT ENOUGH.
CELEBRATION NEEDS A PLACE LIKE THIS.

Celebrations tell volumes about the quality of life that's why Spring Villas has a dedicated Celebration Square where life finds a venue and sometimes reasons to celebrate the colours and beauty of life.

CELEBRATION SQUARE



life is happening

Life happens when you embrace it with all your heart and open arms.

"Club Five Senses" at Spring Villas is designed with a perspective to complement life with all the pleasures so that you can live a life that is truly happening.





club
FIVE SENSES
come alive



KIDS ZONE



RECEPTION ZONE



CELEBRATION ZONE



SPORTS ZONE



HEALTH ZONE



MUSIC & DANCE ROOM



KIDS ZONE

KIDS GET BORED WITH THINGS.
THAT'S WHY YOU HAVE OPTIONS TO EXPLORE.

Being kids is a serious job. We, at Spring Villas, understand it in its totality. Here kids would get enough reasons to be just kids. Let them imagine, create, explore and above all have fun with the occasion called childhood.



INTERACTIVE ROOM



DRAMATIC AREA



TABLE GAME



SNOOZE ROOM



RECEPTION LOBBY



RECEPTION ZONE

Sometimes arriving in style is more important than arriving in life. Reception Zone at Spring Villas is a place where waiting means reading an engrossing book and relaxation means enjoying the hospitality by being the guest of honour. Come, the world is anxiously waiting for you.



GUEST ROOM



READING CORNER



CELEBRATION ZONE

Kitty party for socialising, cards for fun or banquet for get-togethers, whatever is the reason, you would always get a venue to turn them into occasions. Get in the mood to look for more excuses and see how life finds new expressions of happiness in their finest details.



SPORTS ZONE

Find a partner, pool, table tennis, squash court and badminton court are waiting to witness the pro in you. You can call it the art of unwinding while in action. Sports Zone is a reminder that life is all about action and living it to the zone. Your time starts now.

HEALTH ZONE

Health has many faces at Spring Villa. For a calm mind there is yoga, for burning calories, there is gym and for unwinding, there is swimming pool. What's more, here you would get an opportunity to build a community of health-conscious individuals.

YOGA ROOM



CLUBHOUSE PLAN
LOWER GROUND FLOOR ZONES



LEGEND

KIDS ZONE

- 1. Games Room
- 2. Music/Dance Room
- 3. Interactive Room

RECEPTION ZONE

- 4. Reception
- 5. Grand Stairs

CELEBRATION ZONE

- 6. Waiting Area
- 7. Bar/Lobby Area
- 8. Cards Room
- 9. Mini Theatre

SPORTS ZONE

- 10. Squash Court
- 11. Badminton Courts

HEALTH ZONE

- 12. Hot/Ladies Pool
- 13. Deck
- 14. Spa
- 15. Outdoor Pool

OTHERS

- 16. Restaurant
- 17. Amphitheatre
- 18. Celebration Square



CLUBHOUSE PLAN
LOWER GROUND FLOOR ZONES



LEGEND

KIDS ZONE

- 1. Amphitheatre - Kids Area
- 2. Games Room
- 3. Dining Area

RECEPTION ZONE

- 4. Reading Lounge

CELEBRATION ZONE

- 5. Multi-purpose Hall
- 6. Kitchen

SPORTS ZONE

- 7. Table Tennis Room
- 8. Snooker Table
- 9. Pool Table

HEALTH ZONE

- 10. Waiting Area
- 11. Gymnasium
- 12. Yoga Room



 SITE PLAN



LEGEND



ENTRY AREA

- 1a Entry/Exit
- 1b Entry Account Parking
- 1c DriveWay
- 1d Two Plaza
- 1e Planting Island
- 1f Signage Wall
- 1g Entry Portal with Security Cabin
- 1h Waiting Area
- 1i Lawn
- 1j Watered Mosaic
- 1k Accent Plants



PARK AREA-1

- 2a Kids Play Area
- 2b Driveway
- 2c Scooter
- 2d Stamped Plaster
- 2e Fountain
- 2f Walkway



PARK AREA-2

- 3a Landscape Area
- 3b Driveway
- 3c Walkway



STREETSCAPE

- 4a Driveway 7.5M Wide
- 4b Walkway
- 4c Two Grating on Walkway

AREA TABLE

UNIT TYPE	SIZE	FLOOR AREA (SQ. FT.)	CARPET AREA (SQ. FT.)	B.B.A. (SQ. FT.)	Balcony & Deck (SQ. FT.)	S.U.B.A. (SQ. FT.)	TOTAL AREA (SQ. FT.)
Residential-1 (4BR)	30'-0" x 64'-0"	216.00	207.28	158.40	90.85	408.91	766.44
Residential-2 (4BR)	30'-0" x 64'-0"	216.00	206.28	140.70	90.85	408.11	766.94
Residential-3 (3BR)	30'-0" x 64'-0"	216.00	206.96	178.88	117.26	492.11	813.11
Condo-1 (3BR)	30'-0" x 58'-0"	174.00	168.96	142.71	66.45	378.90	657.02
Condo-2 (3BR)	30'-0" x 58'-0"	174.00	168.96	140.39	66.81	376.40	653.56
Condo-3 (4BR)	30'-0" x 58'-0"	174.00	168.97	176.27	111.94	423.11	733.29
Shop-1 (2BR)	27'-0" x 58'-0"	156.60	152.25	101.34	35.40	294.04	545.04
Shop-2 (2BR)	27'-0" x 58'-0"	156.60	152.25	102.40	35.40	294.34	545.34
Shop-3 (2BR)	27'-0" x 58'-0"	156.60	152.07	101.62	35.70	294.64	545.04
Office-1 (2BR)	30'-0" x 58'-0"	174.00	168.48	158.88	49.62	367.11	696.51
Office-2 (2BR)	30'-0" x 58'-0"	174.00	168.48	158.88	49.62	367.11	696.51







MARIGOLD - 1

AREA SHEET

SIZE	30'-0" x 84'-0"
PLOT AREA	216.00 SQ. YDS.
CARPET AREA	2571.39 SQ. FT.
B.I.A.	2507.43 SQ. FT.
BALCONY & DECK	90.85 SQ. FT.
S.R.V.A.	4028.95 SQ. FT.
TERRACE	298.36 SQ. FT.

GROUND FLOOR



FIRST FLOOR



SECOND FLOOR





MARIGOLD - 3

AREA SHEET

SIZE	30'-0" X 84'-0"
PLOT AREA	256.89 SQ. YDS.
CARPET AREA	2791.46 SQ. FT.
B.U.A.	3750.03 SQ. FT.
BALCONY & DECK	157.35 SQ. FT.
S.B.U.A.	4312.53 SQ. FT.
TERRACE	724.41 SQ. FT.





 LAVENDER - 1

AREA SHEET

SIZE	30' 0" X 50' 0"
PLOT AREA	150.00 SQ. YDS.
CARPET AREA	1100.90 SQ. FT.
B.U.A.	2825.22 SQ. FT.
BALCONY & DECK	86.65 SQ. FT.
S.R.V.A.	3030.50 SQ. FT.
TERRACE	1021.65 SQ. FT.





LAVENDER - 2

AREA SHEET

SIZE	30' 0" X 30' 0"
PLOT AREA	360.44 SQ. YDS.
CARPET AREA	1900.93 SQ. FT.
R.V.A.	2633.39 SQ. FT.
BALCONY & DECK	86.65 SQ. FT.
S.R.V.A.	3026.40 SQ. FT.
TERRACE	1022.36 SQ. FT.



GROUND FLOOR

FIRST FLOOR



LAVENDER - 3

AREA SHEET

SIZE	30' 0" X 30' 0"
PLOT AREA	360.44 SQ. YDS.
CARPET AREA	1950.41 SQ. FT.
R.V.A.	2716.27 SQ. FT.
BALCONY & DECK	155.54 SQ. FT.
S.R.V.A.	3123.71 SQ. FT.
TERRACE	613.87 SQ. FT.



GROUND FLOOR

FIRST FLOOR





TULIP - 2

AREA SHEET

SIZE	21'-0"X50'-0"
PLOT AREA	120.33 SQ. YDS.
CARPET AREA	1532.35 SQ. FT.
B.I.A.	2012.42 SQ. FT.
BALCONY & DECK	58.45 SQ. FT.
S.B.I.A.	2338.28 SQ. FT.
TERRACE	790.07 SQ. FT.



TULIP - 3

AREA SHEET

SIZE	21'-0"X50'-0"
PLOT AREA	120.33 SQ. YDS.
CARPET AREA	1510.17 SQ. FT.
B.I.A.	2033.62 SQ. FT.
BALCONY & DECK	110.53 SQ. FT.
S.B.I.A.	2338.66 SQ. FT.
TERRACE	794.69 SQ. FT.





IRIS - 1

AREA SHEET

SIZE	11' 0" x 50' 0"
PLOT AREA	105.56 SQ. YDS.
CARPET AREA	1210.40 SQ. FT.
B.U.A.	1589.00 SQ. FT.
BALCONY & DECK	491.62 SQ. FT.
S.B.U.A.	1827.35 SQ. FT.
TERRACE	896.53 SQ. FT.



GROUND FLOOR



FIRST FLOOR



IRIS - 2

AREA SHEET

SIZE	18'-0" X 50'-0"
PLOT AREA	105.50 SQ. YDS.
CARPET AREA	1210.40 SQ. FT.
B.O.A.	1189.00 SQ. FT.
BALCONY & DECK	49.62 SQ. FT.
S.B.V.A.	1827.35 SQ. FT.
TERRACE	607.53 SQ. FT.

GROUND FLOOR



FIRST FLOOR

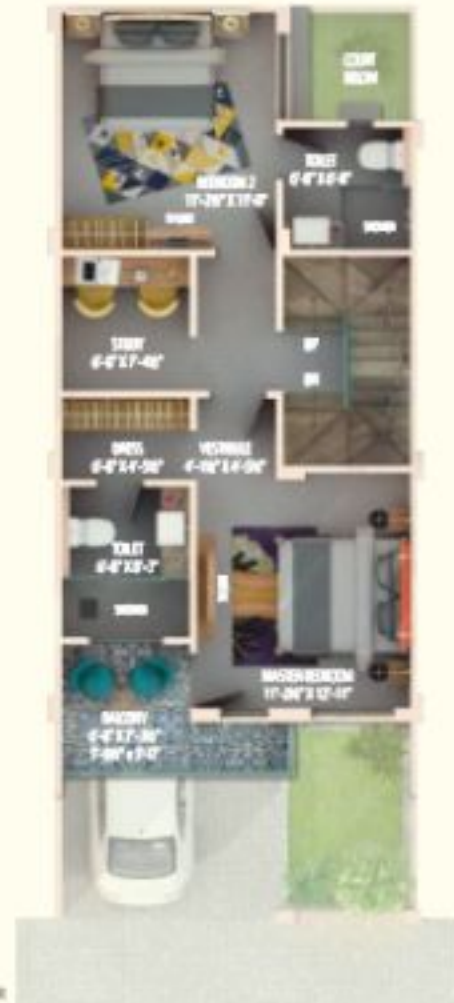

SPECIFICATIONS

Living/Dining

Flooring	Verified flooring
Skirting	Verified profile
Wall Finishes	Plaster with POP and O.B.D.
Ceiling	Plaster with POP and O.B.D.

Master Bedroom

Flooring	Verified flooring
Skirting	Verified profile
Wall Finishes	Plaster with POP and O.B.D.
Ceiling	Plaster with POP and O.B.D.

Other Bedrooms

Flooring	Verified flooring
Skirting	Verified profile
Wall Finishes	Plaster with POP and O.B.D.
Ceiling	Plaster with POP and O.B.D.

Toilets

Flooring	Anti-skid ceramic tiles
Wall Finishes	Ceramic tiles up to 7'-0" height
CP Fittings & Sanitary Fittings	6 rest plaster with POP & O.B.D.
	European wall hung WC, under/over counter basin/basin with pedestal in all the toilets of renowned brands like Kohler/Jaque/Roca or equivalent
	Brush steel finish C.P. fixtures of renowned brands like Kohler/Jaque/Roca or equivalent
	Separate dry and wet areas
Hygiene	

Kitchen

Flooring	Verified/anti-skid matt finish tiles
Skirting	Tile profile
Wall Finishes	Plaster with POP and O.B.D.
Wall Tiles	Tiles upto 2' height above counter top
Counter Top	Premium granite
Sink	Stainless steel sink with drain board
CP Fittings	Brushed steel finish sink mixer

Balcony

Flooring	Anti-skid ceramic tiles
Skirting	Tile profile
Railing	Glass railing

Staircase

Riser and Tread	Natural stone/tiles
M.S. Staircase with Railing	

Doors and Windows

Main Door	Flush door with Veneer/laminate on both sides/ready made designer doors or equivalent
Other Doors	Ready-made designer doors/flush doors or equivalent
Windows	Aluminium powder coated/UPVC
Ventilators	Aluminium powder coated/UPVC

General Specification for Villas

1. Designer modern facade
2. Power back-up of 1 KVA in each villa
3. Plantation in each villa
4. Copper piping for air-conditioning in each villa
5. Provision for LPG line in kitchen

Common Facilities

- SERVICES**
1. Power back-up for common services
 2. Garbage collection point
 3. Wi-Fi club building
 4. Landline/Internet facility
 5. Provision for DTH
 6. CCTV at entrance
 7. Car washing area
 8. Rainwater harvesting system
 9. Sewerage treatment plant

STRUCTURE AND SERVICES

1. Earthquake resistant structure
2. Energy efficient, green eco-friendly nominal design, centralized grouped location of services installation to ensure easy maintenance, state-of-the-art technology, fast track installation and compliance to all statutory regulations

Electricals

1. High side electrical equipment transformer, panels etc. of requisite designed capacity
2. Electrical fittings & concealed copper wiring in PVC conduit
3. Separate meter for lighting in common areas and pumps
4. 16 Amps sockets for geysers in toilets and 25 Amps sockets for air-conditioners in all bedrooms
5. Adequate nos. of 6 Amps sockets & 16 Amps sockets in kitchen
6. Adequate 16 Amps plug sockets in each room
7. One calling bell along with bell push



THE MAKERS



MAHIMA GROUP
Committed to Excellence

Mahima Group is the pioneer of real estate in Rajasthan with 32 years of strong presence across various verticals of infrastructure development. The group boasts a highly motivated team of more than 300+ professionals working in various capacities to realize the larger vision in its true sense. In its existence of more than 7 decades, Mahima Group has successfully delivered 4850 residential and commercial units that cover 8 million sq. ft. of development. In commercial development, 4 large commercial malls were delivered that houses more than 100+ renowned national and international brands. The extended Mahima family includes 9000+ happy families that are residing in various projects of the group. Currently Mahima Group is developing 3.60 million sq. ft. of space that includes 1640 units across 7 ongoing projects. The group also runs 360 degree facility and project cycle management services that maintain its various completed projects in a very efficient and professional way. With a passion to bring about a meaningful change in the lifestyle of contemporary society, Mahima is on a mission called "Constructing Your World".

BENEFITS OF BUYING A HOME FROM MAHIMA

- 32 years of excellence in real estate industry
- Committed to on-time delivery
- Choose from wide range of apartments
- Options to choose your home loan provider as per your requirement
- Professional in-house facility management company with dedicated customer care helpline number for hassle-free living
- Safe & secure environment in all the projects
- Free interior designing consultation



Mahima Advisory Services is a turnkey rental & resale service enterprise of Mahima Group which works as a dedicated value added service for Group's ready-to-move-in properties. The core objective of Mahima Advisory Services is to find appropriate tenants for its customers and help them in increasing their income. On a monthly basis, it does 40-50 rentals. On one hand Mahima Advisory Services is ensuring great returns for owners and on the other, it is making Mahima properties happening and livable. The service also gives tenants wide options in various budgets and locations and also an opportunity to live in premium properties. To make Mahima properties the first choice for rental customers, the group strives hard to maintain its visibility across various media. Besides this, to give an excellent and hassle-free shifting experience to tenants, Mahima Advisory Services also provides them info on basic services like packers & movers, schools, hospitals, shopping malls and domestic help. Mahima Advisory Services' active and meaningful help is changing the rental perspective of both owner and tenant and giving it a positive outlook. Built on the true platform of Mahima Group, Mahima Advisory Services on one hand is making rental experience for owner and tenant smooth and on the other the company is also pioneering the dawn of a new tomorrow in professional rental services.

WE WILL HELP YOU FIND

- PACKERS & MOVERS
- NEARBY SHOPPING MALLS
- NEARBY SCHOOLS
- UTILITY SERVICE PROVIDERS
- NEARBY HOSPITALS
- DOMESTIC HELP SERVICE PROVIDERS



THE MAKERS

COMPLETED PROJECTS (RESIDENTIAL)



ON GOING PROJECTS (RESIDENTIAL)



COMPLETED PROJECTS (COMMERCIAL)



FINETECH

In house maintenance & facility management company

Mahira Group believes and works to adhere the single line philosophy that says "nothing stands stronger for a lifetime than trust". Team Mahira relentlessly works to deliver complete peace of mind to its valued customers even after the sale is completed. To take care of the property and ensure security of residents, Finetech Facilities Management works round-the-clock under the able supervision of Mr. Nishi Madan. It is about delivering 360 degree facility and management services to the residents of all Mahira projects. Core work areas of the company include common services, sanitation, cleanliness and security.